

CRETA GRAND





Step it up.

The popular CRETA takes you a step higher with CRETA GRAND to give you extra passenger and cargo carrying capability, added safety features, and more of everything you want and need in a subcompact crossover. Designed to exceed all expectations, CRETA GRAND offers a surprisingly roomy and well-appointed cabin plus a choice of advanced power-trains that deliver outstanding pickup performance with impressive fuel economy.



Radiating supreme confidence.

Modern, sporty, and masculine—it's just my style, it's in perfect tune with my sensibilities, and it fits in anywhere. From any angle, CRETA GRAND projects supreme confidence and authority. Your fascination only grows as you move in closer to examine the details: The LED lighting, the strikingly-designed diamond-cut alloy wheels, and the catchy-looking radiator grille. But the real centre of attention and even greater delights await you inside.



Signature cascading grille with dark chrome finish



LED headlamps with LED DRLs
18" diamond-cut alloy wheels





10.25" TFT LCD cluster



8" touchscreen



2nd row wireless phone charger

Pure delight.

CRETA GRAND delivers on its promise with a grand-sized cabin that is not only bigger but smarter. You'll discover thoughtful design touches and experience pure joy in every detail. From the innovative mechanisms that simplify seat adjustment to the abundance of cabin space, CRETA GRAND is designed to make a grand impression. The two-tone interior color scheme and perforated leather seats (optional) create a luxurious atmosphere.



7 seats

3rd row folded

3rd row folded and 2nd row folded 40%

3rd row folded and 2nd row folded 60%

2nd and 3rd row folded



Versatile storage space

The large luggage space will fit just about anything. And if it doesn't fit, you can easily triple the storage space by folding down the 2nd-row and 3rd-row backrests—It's as easy as 1-2-3. Now that's versatile!



2nd-row console box (6-seater)

The highly versatile center console box serves both as a padded armrest, a handy storage binacle and comes with a wireless phone charger and built-in dual cupholders.



2nd row seat folding system with 3rd row seats

Just touch the button to move the 2nd-row seats to and fro, or fold down the backrests to provide 3rd-row passengers with easier entry and egress.



Flex that muscle.

Mostly you go with the flow, but sometimes you have to make a move and assert yourself. CRETA GRAND's advanced powertrains deliver all the power you need for effortless acceleration and passing on the highway. The G2.0 gasoline engine is made of weight-saving aluminum and comes with Multi-Point Fuel Injection, Dual Overhead Camshafts and Dual Continuously Variable Valve Timing to maximize fuel economy and horsepower. The U2 diesel is fitted with the latest Variable Geometry Turbocharger to force extra air into the combustion chamber for higher torque output. Plus, CRETA GRAND offers you a choice of 6-speed transmissions to suit your driving style.

Smartstream G2.0 gasoline (6-Speed MT / AT)

159 Maximum Power
ps/6,500 rpm

19.5 Maximum Torque
kg-m/4,500 rpm

U2 1.5 VGT diesel (6-Speed MT / AT)



115 Maximum Power
ps/4,000 rpm

25.5 Maximum Torque
kg-m/1,500 - 2,750 rpm



Traction Control Mode

By regulating slip control for the right/left wheels while adjusting engine torque and gear shift patterns, the Traction Control Mode automatically fine tunes CRETA GRAND's front wheel drive system to adapt to difficult driving conditions. Optional.

-  **SNOW**
When the roads are icy and snow-covered, this setting ensures optimal traction to keep you moving safely and confidently.
-  **SAND**
Driving over sand poses special challenges but selecting the Sand setting minimizes wheel slip to keep you out of trouble.
-  **MUD**
When tires fail to grip because of mud, this setting automatically applies the correct amount of torque to the left and right wheels to reduce slippage.

* Drive mode : SPORT, ECO, NORMAL

Always on guard for you.

Though the road ahead is filled with uncertainties, CRETA GRAND's advanced safety systems provide you with complete peace of mind. Special crush zones serve as your first line of defense. Made of ultra-high tensile strength steel and embedded in critical areas, these structures are designed to safely absorb impact forces and protect cabin occupants in the event of a collision. The Blind Spot View Monitor always looks over your shoulder and will alert you if you try to make an unsafe lane change.



Tyre Pressure Monitor System (TPMS)
TPMS helps you achieve optimal fuel economy and extends tire life by alerting you if the tires require attention.



Hillstart Assist Control
When starting from a stop on a hill, HAC prevents the unintentional rollback that can occur after the brake pedal is released.



6-airbag system (Driver, Passenger, Side & Curtain)
CRETA GRAND offers 6 airbags: the driver and front passenger get a pair of front airbags plus a pair of side airbags to protect the thorax and pelvic areas while left and right curtain airbags offer head protection for all cabin occupants.



Blind-Spot View Monitor (BVM)
When the turn signals are activated, the rear-side image of the corresponding direction is displayed in the cluster.



Surround View Monitor (SVM)
A multi-camera system provides a 360-degree view around the vehicle to assist the driver in parking situations.

Features



17" Alloy wheels 18" Alloy wheels



Front distance warning



LED MFR headlamps & LED DRLs



Front fog lamps (LED MFR)



Panoramic sunroof



LED rear combination lamp



Puddle lamp with Hyundai logo projection



Full automatic temperature controls



Electric Parking Brake with Auto Hold



Driver's 8-way power seat



BOSE premium sound system



64-Color ambient mood lamp



Front ventilated seats



Rear door manual curtain



Front row seatback table with retractable cup-holder and IT device holder



3rd-row AC vents with 3-speed fan control

* Features and specifications vary by market. Please consult your local dealer.

Exterior colors



PWT Polar White	T2X Typhoon Silver	R4G Titan Grey	X5B Phantom Black	UB7 Midnight Blue	RN7 Taiga Brown	R41 Titan Grey + Phantom Black roof	TTB Polar White + Phantom Black roof
---------------------------	------------------------------	--------------------------	-----------------------------	-----------------------------	---------------------------	--	---

Interior colors

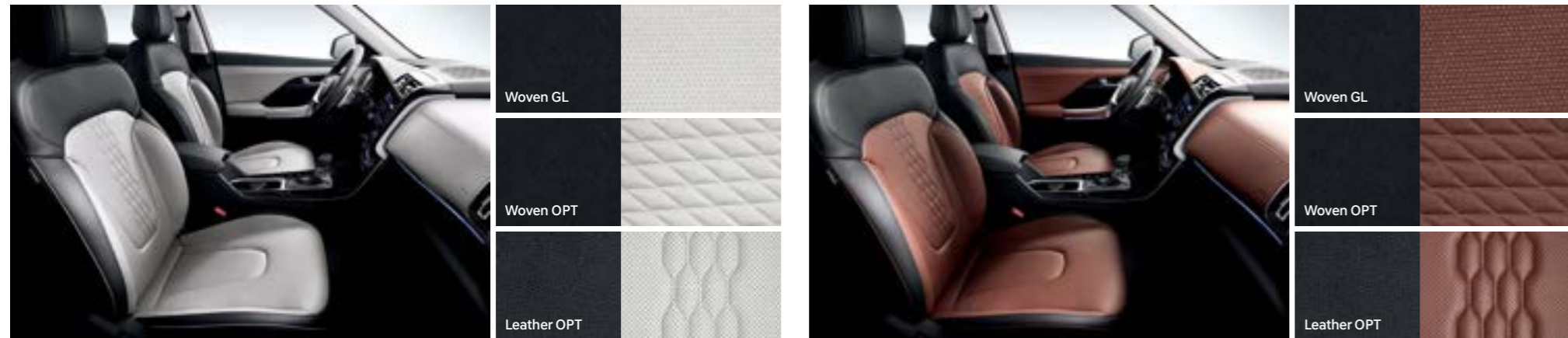

Black / Gray two-tone interior

Black / Brown two-tone interior

Specifications

Type	Smartstream G2.0 gasoline	U2 1.5 VGT diesel
Engine type	4 Cylinders, 16 Valves, HLA	4 Cylinders, 16 Valves, HLA
Displacement (cc)	1,999	1,493
Max. Power (ps / rpm)	159 / 6,500	115 / 4,000
Max. Torque (kg-m / rpm)	19.5 / 4,500	25.5 / 1,500-2,750
Brakes		
Front	16" ventilated discs	
Rear	15" solid discs	
Suspension		
Front	MacPherson strut	
Rear	Coupled Torsion Beam Axle (2WD)	
Tire	215/60R17, 215/55R18	

Dimensions		
Head room (mm)	1st row (w/Sunroof) / 2nd row (w/Sunroof) / 3rd row	1,046 (993) / 1,039 (986) / 950
Leg room (mm)	1st row / 2nd row / 3rd row	1,051 / 900 / 800
Shoulder room (mm)	1st row / 2nd row / 3rd row	1,404 / 1,390 / 1,252

- The above values are based on internal testing results and are subject to change after validation.
- Some of the equipment illustrated or described in this catalog may not be supplied as standard equipment and may be available at extra cost.
- Hyundai Motor Company reserves the right to change specifications and equipment without prior notice.
- The color plates shown may vary slightly from the actual colors due to the limitations of the printing process.
- Please consult your dealer for full information and availability on colors and trims.



Overall Width 1,790
Wheel Tread 1,595.5



Overall Length 4,500
Wheel Base 2,760

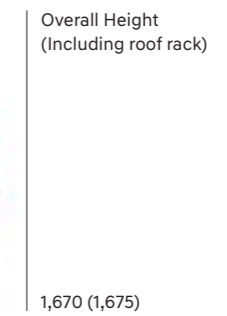

Overall Height (Including roof rack) 1,670 (1,675)



Wheel Tread 1,564.3

Unit : mm

Dealer stamp